

$\phi 910 \begin{smallmatrix} 0 \\ -0.42 \end{smallmatrix}$

压力角	α	20°
-----	----------	------------

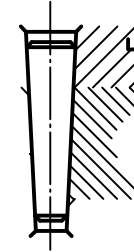
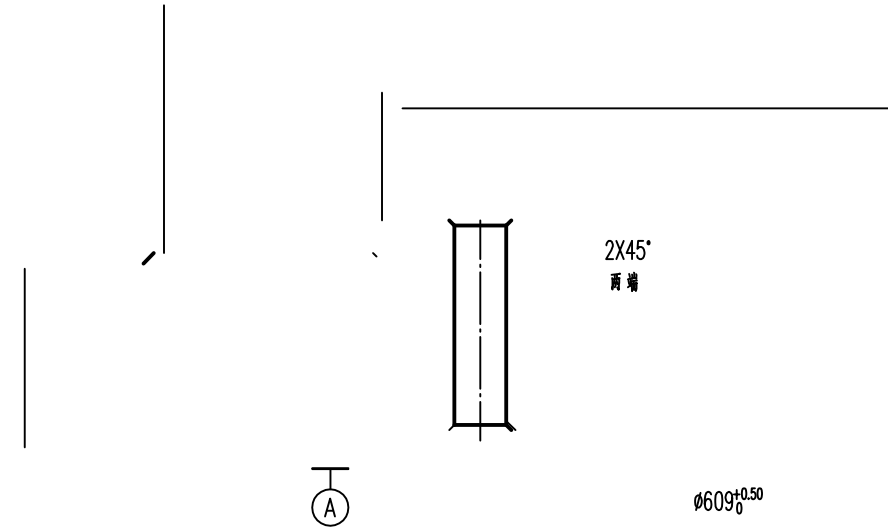

$3 \times 45^\circ$

$3 \times 45^\circ$

安装孔 $24-M20$ 均布

22

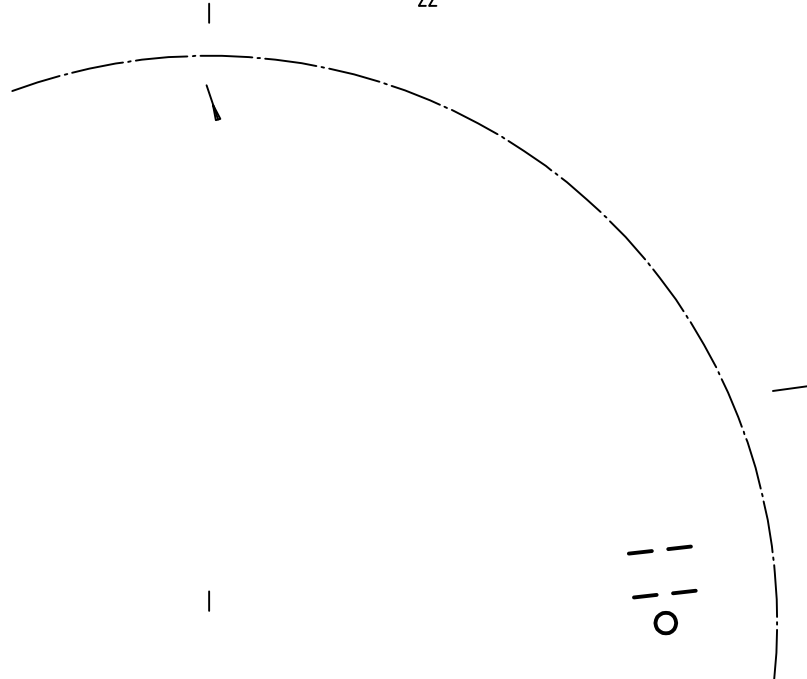

4 装配后在轴承端面标志 : LYDZ 01-910, 轮毂位置用“S”标记

5. 交货状态轴承注入锂基润滑脂, 并带2个油嘴

钢 42CrMo-GB/T2033
钢 42CrMo-GB/T2033
轮毂

钢 42CrMo-GB/T2033
42CrMo-GB/T2033